

THE ULTIMATE GAME OF TAG

LASER CHALLENGE™

GOTCHA EXTREME!

MINI MAYHEM™

INSTRUCTIONS

Are you ready to get EXTREME? Laser Challenge™ Gotcha Extreme™ Mini Mayhem™ is the evolution of the Laser Challenge™ Game...

Laser Challenge™ Gotcha Extreme™ Mini Mayhem™ games can be as complex or as simple as you would like. It is highly recommended that you read the following instructions before playing Laser Challenge™ Gotcha Extreme™ Mini Mayhem™.

Laser Challenge™ Gotcha Extreme™ Mini Mayhem™ Includes:

- 1 Laser Challenge™ Gotcha Extreme™ Mini Mayhem™ Blasters with Tethered Sensor Vests.

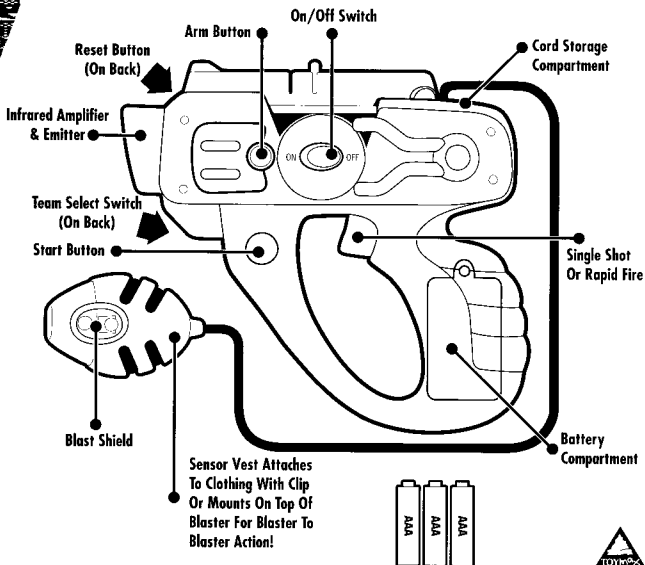

Set Up:

Batteries:

- Each Laser Challenge™ Mini Mayhem™ requires 3 "AAA" Batteries (not included)

NOTE: NO BATTERIES ARE REQUIRED FOR THE SENSOR VESTS.

- Ask an adult to remove the battery covers and install the batteries
- Be sure the battery polarities are correct.

NOTE: Laser Challenge™ Gotcha Extreme™ Mini Mayhem™

Equipment works best with new batteries-Remove the batteries that came with your new Laser Challenge™ game and replace them with fresh ones.

IMPORTANT: BEFORE REPLACING THE BATTERY COVER, SLIDE THE SWITCH THAT IS IN THE BATTERY COMPARTMENT FROM THE "TRY ME" TO THE "PLAY" POSITION!

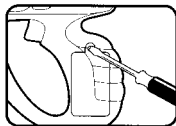

Remove the Battery Cover.

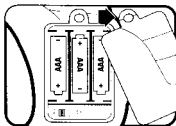

Install 3 AAA Batteries.

Vest:

- Your Laser Challenge Mini Mayhem Sensor Vest can either be clipped to your clothing for Blaster to Vest play or mounted on your blaster for Blaster to Blaster play!

NOTE: If you choose to mount your Sensor Vest on Your blaster, you can tuck the cord inside the storage compartment.



Sensor Vest can be worn on clothing...

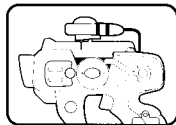

Sensor Vest can be mounted on a Blaster!

Starting the Game:

Common Mode:

In "Common Mode", the basic features including reset, fire, Blast Shield and hits will work with all other Laser Challenge™ equipment including the original Laser Challenge™, Laser Challenge™ Pro™, Laser Challenge™ Micro Max™, Laser Challenge™ V2™, and Laser Challenge™ Cyber Splash™.

- Advanced features such as Team Select and RADAR will NOT work with any other Laser Challenge™ Equipment other than the Radar Extreme™ and Gotcha Extreme™ sets.
- In "Common Mode" the RADAR and Team Select features are NOT available.

NOTE: Laser Challenge™ Gotcha Extreme does NOT work with the Laser Challenge™ V2 ELS Game System.

To Play in "Common Mode":

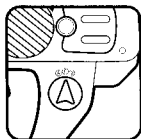

1. Turn the Team Select switch to the "C" position.



2. Turn Laser to the "ON" position by sliding the on/off switch forward.

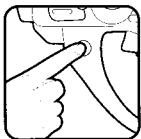

3. Press the START button on your Blaster.



4. Aim a laser at any vest and press the RESET button to reset the laser and the vest.

NOTE: ALL VESTS AND ALL LASERS MUST BE RESET PRIOR TO STARTING A GAME.

Reload:

- In order to fire, you must reload your Blaster. To reload press the Arm button.
- Each reload will give you 10 shots.
- Your laser can rapid-fire by pressing the trigger repeatedly.
- When you are out of shots you will hear a "click" from your Blaster indicating that you need to reload.

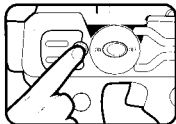

To reload, press the arm button.

NOTE: You can reload as many times as you wish each game.

Hits:

- Once your vest has been reset, your vest can be hit!
- Each time a vest is hit, the electronic display will flash and the hit sounds will be heard.
- On the ninth hit, a warning tone will alert the player that there is one more hit before elimination.
- After 10 hits the player is eliminated and the vest will shut down.

Blast Shield:

- A Blast Shield gives you a 5 second period of time in which your vest cannot be hit.
- 30 seconds after your vest has been reset, you will hear a tone from your vest indicating that your Blast Shield feature is available.

To select a Blast Shield:

1. Press the Blast Shield Button on the vest
2. The Blast Shield indicator light will flash indicating that you are protected.

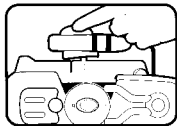

NOTE: You can only use the Blast Shield function 3 times per game.

"Team Select" Mode:

- Team Select Mode is an advanced feature found only in Laser Challenge™ Gotcha Extreme™ Systems.
- The team select mode allows you to set your laser and vest to one of two different teams (Team A or Team B).

NOTE: Either of the Lasers and Vests (red or blue) can be set to Team A or Team B.

- In Team Select Mode the Radar feature is active and the Lasers and Vest will not allow members of the same team to HIT each other.

RADAR Feature:

- The RADAR feature is an audible tone that will alert you when an opponent (member of the opposite team) has his laser pointed at your vest. The purpose of the RADAR feature is to allow you enough time to get out of your opponents blasting zone before you are hit.

To Play in Team Select Mode:

- Before starting the game the players must decide which players will be on Team A and which players will be on Team B.
- Blasters set for the same team (A or B) will not register a "HIT" should they accidentally shoot at each other.

To Select Team A or Team B:

Before turning your Blasters on, slide the team select switch to either the A position for TEAM A or the B position for TEAM B.

NOTE: A Blaster set to Team A can NOT reset another Team A Blaster. A Blaster set to Team B can NOT reset another Team B Blaster. New games can only begin when opposing A and B Blasters are reset.

**Be Responsible.
Never point your laser at anyone that is not a player**

We're Always Here to Help!
We know you are going to enjoy playing with your
Laser Challenge™
If you have any questions or comments, our
Customer Service Representatives will be glad to help.

Call 1-800-222-9060
Between 9:00 am and 5:00 pm EST.
Monday through Friday, or write to:
TOYMAX INC.

Visit us on the internet at:
www.laser-challenge.com

Conforms to ASTM-F963
Colors & Contents May Vary.
© 2001 Toymax Inc. Plainview, NY 11803 U.S.A. All Right Reserved.
TM and ® Designate Trademarks of Toymax INC. & Toymax (H.K.) LTD
Printed in China
806467/1

- Never mix old & new batteries.
- Never mix alkaline, standard (carbon-zinc) or rechargeable (nickel-cadmium) batteries.
- Do not use rechargeable batteries.
- Firing distance may be affected by weather and lighting conditions.
- Infrared beam cannot be seen.
- Does not contain a real laser device.
- Do not dispose of batteries in fire, batteries may explode or leak.

